

Instructions

where to get the app:

1. Search "Smart Aroma" in Google play or app store and you will find it.

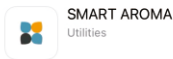

GET

add the app and install to your mobile

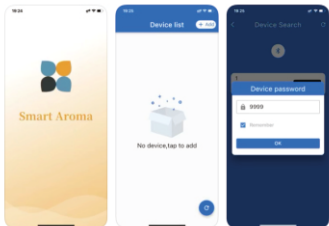

2. Open bluetooth from your mobile setting and Search your purchased device

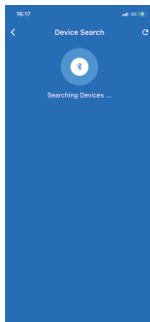

click Refresh button

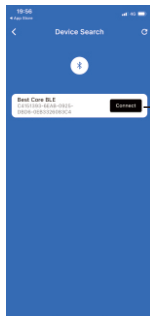

Connect device

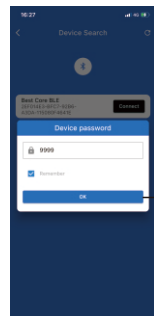

press OK button to set device

3. How to set the device by mobile

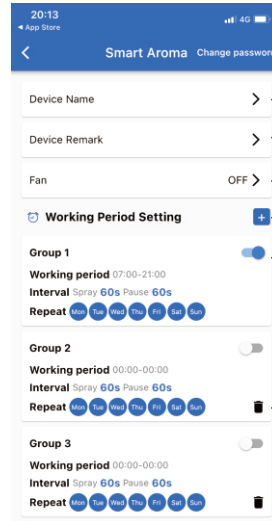

Amend device name

Remark location

Built in Fan level (OFF/HIGH/LOW)

Add working groups(PS:there are 5 working groups available to set)

Group 1 ON/OFF switch

Delete this working group setting

4. Working period setting

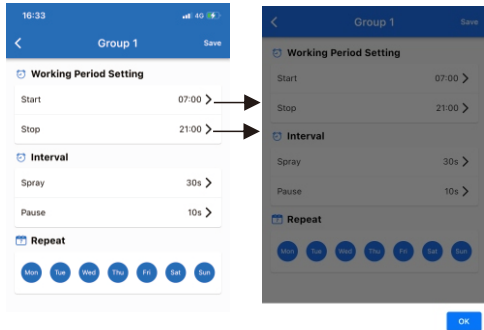

Slide UP and DOWN to adjust, press OK to save it

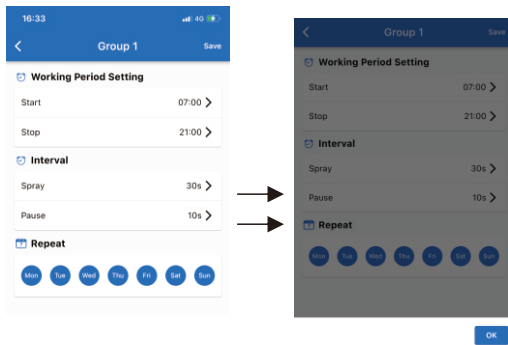

Slide UP and DOWN to adjust, press OK to save it



After setting, please save it before going back to the home page

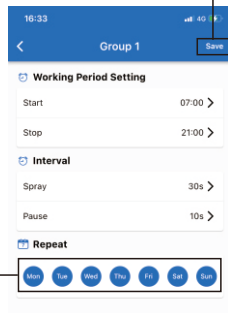

Select the day

5. Amend password

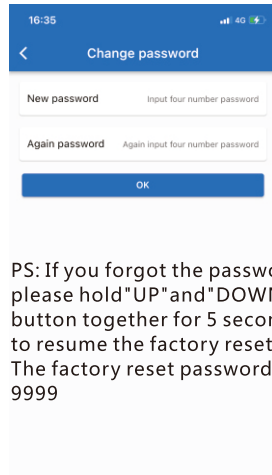
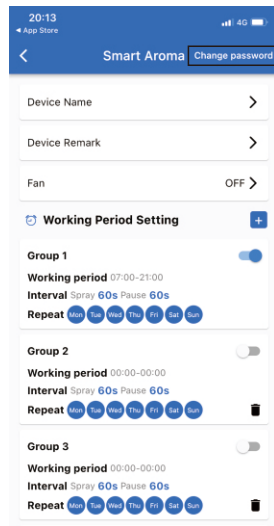

PS: If you forgot the password, please hold "UP" and "DOWN" button together for 5 seconds to resume the factory reset. The factory reset password is 9999